

HAMMER DRIVE RIVETS -SIM

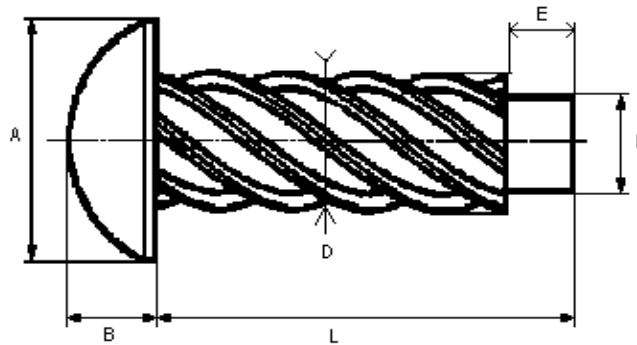

	Références	11P	9P	6P	4P
D	Shank diameter	2,3	2,9	3,9	4,6
A	Head diameter	5,35 - 6,65	7,70 - 8,10	8,28 - 8,72	9,75 - 10,25
B	Head thickness	0,77 - 1,03	0,87 - 1,13	1,37 - 1,63	1,37 - 1,63
E	Chamfer diameter	1,79 - 1,95	2,34 - 2,44	3,10 - 3,20	3,71 - 3,81
F	Chamfer length	1,20	1,20	1,20	1,20
L	Length under head	4,80	6,40	6,40	6,40

The assembly is done by pressing the hammer drive rivets in the drilling of the female rivet until the immobilization of the parts

The assemblies parts look the same on both sides

News : possibility to produce following 2P form for hole diameter 8 mm.